

Great Guns TAILORED TO YOU by HIGH STANDARD



Choice of Champions

SUPERMATIC "DELUXE"

PARTS LIST FOR 12 GAUGE AUTOLOADING SHOTGUN MODELS C-1200 and C-1211

CAT. #8204	PLAIN BARREL - FULL CHOKE 28"	MODEL C - 1200
CAT. #8205	PLAIN BARREL - MOD. CHOKE 28"	MODEL C - 1200
CAT. #8206	PLAIN BARREL - IMP. CYL. 26"	MODEL C - 1200
CAT. #8207	PLAIN BARREL - FULL CHOKE 30"	MODEL C - 1200
CAT. #8251	BARREL w/ADJUSTABLE CHOKE 27"	MODEL C - 1200
CAT. #8224	BARREL w/RIB - FULL CHOKE 30"	MODEL C - 1200
CAT. #8225	BARREL w/RIB - FULL CHOKE 28"	MODEL C - 1200
CAT. #8226	BARREL w/RIB - MOD. CHOKE 28"	MODEL C - 1200
CAT. #8232	BARREL w/RIB & ADJUSTABLE CHOKE 27"	MODEL C - 1200
CAT. #8246	PLAIN BARREL - (DEER GUN) 22"	MODEL C - 1200
CAT. #8264	BARREL w/RIB - (SKEET GUN) 26"	MODEL C - 1200
CAT. #8265	BARREL w/RIB - (TRAP GUN) 30"	MODEL C - 1200
CAT. #8244	PLAIN BARREL - (DUCK GUN) 30"	MODEL C - 1211
CAT. #8247	BARREL w/RIB - (DUCK GUN) 30"	MODEL C - 1211

HOW TO ORDER REPAIR PARTS

The following information must be furnished when ordering replacement parts:

1. Model Name and Number
2. Catalog Number
3. Number and Name of Parts

SHOTGUN SHIPPING INSTRUCTIONS

CAUTION: For safety of all concerned - Be absolutely certain shotgun is empty . . . with no shells in chamber and magazine.

Shotgun should be securely packaged in a throwaway carton to prevent damage in transit. Do not ship shotgun to the factory in gun carrying case or other special containers which must be returned by our service department.

Shotgun should be shipped to the factory - Express Prepaid or insured parcel post.

REMEMBER: All Shipments to the factory must be Prepaid.

FACTORY SERVICE

If parts are to be fitted at the factory, send firearms marked for the attention of our SERVICE DEPARTMENT, furnishing complete and specific repair instructions. A cost estimate of the parts and labor charges will be immediately sent for your approval before work is started. Unless a flat rate charge is specified, a MINIMUM of \$6.50 will be charged on servicing firearms at the factory.

MINIMUM ORDER \$1.00

A minimum charge of \$1.00 is made on all orders where the normal cost would be less than \$1.00. If you wish, order extra parts to make up the minimum charge.

PAYMENT

All parts shipments will be made by Parcel Post C.O.D. unless advance remittance is made. PLEASE DO NOT SEND CASH OR STAMPS. Checks, Money Orders, or Drafts are acceptable and will save you C.O.D. charges.

THE HIGH STANDARD MFG. CORP., HAMDEN, CONNECTICUT

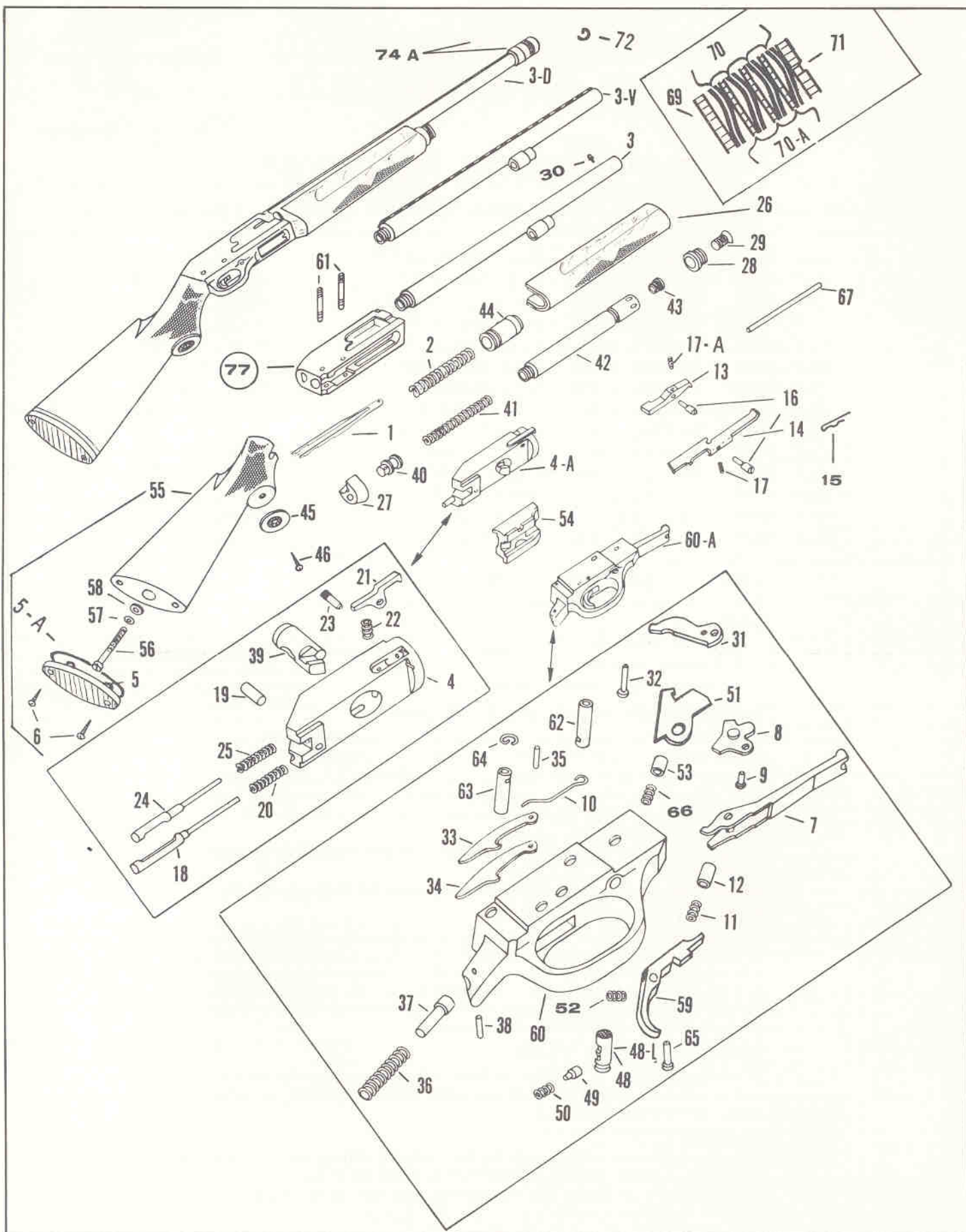

CAUTION: FOR SAFETY'S SAKE DO NOT ATTEMPT TO REPAIR SHOT GUN WITHOUT RECEIVING RELIABLE

PARTS LIST FOR SUPERMATIC 12 GAUGE AUTOLOADING SHOT GUN

All parts identified with an (†) must be fitted to the gun by qualified gunsmiths. (††) Sold for factory installation only. Return complete shotgun to factory. Do not order repair parts by key number, always use the part number.

(PRICES SUBJECT TO CHANGE WITHOUT NOTICE)

NOTE: BARREL IS STAMPED ON LEFT WITH ONE OR MORE (*) WHICH SPECIFIES BARREL CHOKE.

* — FULL CHOKE
** — MODIFIED CHOKE

*** — IMPROVED CYLINDER
**** — SKEET BORE

REF. NO.	PART NO.	DESCRIPTION	RETAIL PRICE EACH	REF. NO.	PART NO.	DESCRIPTION	RETAIL PRICE EACH
1	2216	Action Bar	\$ 9.50	27	2221	Forehand Base	\$ 2.00
2	733	Action Spring	.85	28	2254	Forehand Cap	1.50
3	††2213	Barrel 30" Plain (Duck Only)	36.00	29	6653	Forehand Cap Screw	.25
3V	††2214	Barrel 30" w/Rib (Duck Only)	47.50	30	130	Front Sight	.25
N.I.	††2250	Barrel 27" w/Rib w/Adjustable Choke (Deluxe)	36.00	N.I.	500	Front Sight (Deer Gun)	1.25
3	††2226	Barrel 26" (Improved Cyl.) Plain (Deluxe)	30.00	31	† 876	Hammer	2.50
3	††2208	Barrel 28" (Specify Choke) Plain (Deluxe)	30.00	32	699	Hammer Hinge Pin	.25
3V	††2238	Barrel 28" (Specify Choke) w/Rib (Deluxe)	41.50	33	641	Hammer Strut, R.H.	.35
3	††2224	Barrel 30" (Full Choke) Plain (Deluxe)	30.00	34	642	Hammer Strut, L.H.	.35
3V	††2246	Barrel 30" (Full Choke w/Rib (Deluxe)	41.50	35	643	Hammer Strut Pin	.25
N.I.	††2248	Barrel 27" Plain w/Adjustable Choke (Deluxe)	36.00	36	762	Hammer Spring	.25
3V	††2020	Barrel Assy. 12 Ga. 26" w/Rib and Sight (Skeet)	50.00	37	639	Hammer Spring Guide	.25
3V	††2050	Barrel Assy. 12 Ga. 30" w/Rib and Sight (Trap)	41.50	38	676	Hammer Spring Ret. Pin	.25
3	††2080	Barrel Assy. 12 Ga. 22" Plain w/Rifle Sights (Deer)	36.00	39	† 691	Locking Pin	3.00
4	† 756	Bolt	14.00	40	645	Magazine Follower	.50
4A	785	Bolt Assembly	23.00	41	2263	Magazine Spring	.50
5	620	Butt Plate w/Screws	1.30	42	2264	Magazine Tube	4.50
5A	2016	Butt Plate Trim (1)	.80	43	648	Magazine Tube Cap	.95
6	345	Butt Plate Screws (2)	.25	44	† 2230	Piston	3.00
7	8623	Cartridge Lifter	5.00	45	401	Pistol Grip Cap (Black) w/Screw	.40
8	677	Cartridge Lifter Actuator Assembly	.90	46	403	Pistol Grip Cap Screw	.25
9	610	Cartridge Lifter Actuator Hinge Pin	.25	N.I.	587M	Rear Sight (Deer Gun)	2.25
10	675	Cartridge Lifter Actuator Spring	.25	N.I.	565	Rear Sight Elevator (Deer Gun)	.30
11	897	Cartridge Lifter Spring	.25	N.I.	568	Rear Sight Filler Screws (Deer Gun)	.25
12	689	Cartridge Lifter Spring Plunger	.25	N.I.	6752	Recoil Pad (Trap)	2.50
13	612	Cartridge Stop, R.H.	2.50	N.I.	152	Recoil Pad Screws (2) each (Duck, Trap)	.25
14	2244	Cartridge Stop, L.H.	4.50	N.I.	2145	Rib Bead Sight (Trap)	.25
16	864	Cartridge Stop Pin (2) each	.25	48	8627	Safety Button, R.H.	.75
15	865	Cartridge Stop Pin Retaining Clip (2) each	.25	48L	8628	Safety Button, L.H.	1.00
17A	656	Cartridge Stop Spring, R.H.	.25			(Deluxe, Citation, Trophy, Duck, Skeet, Trap)	
17	777	Cartridge Stop Spring, L.H.	.25	49	605	Safety Spring Plunger	.25
N.I.	766	Choke Cap	3.50	50	155-B	Safety Plunger Spring	.25
72	11628	Choke Click Spring	.35	54	2219	Slide	6.00
74A	† 8768	Choke Assembly w/Plain Barrel	8.00	55	2252	Stock Assembly (Checked)	19.50
74A	† 8779	Choke Assembly w/Rib	8.00			(w/Recoil Pad & Screws)	
N.I.	2409	Cocking Handle	1.50	N.I.	2260	Stock Assembly (Select Walnut) (Skeet)	25.00
69	† 752	Cylinder Washer	.60	N.I.	2262	Stock Assembly (Select Walnut) (Trap)	35.00
71	† 754	Cylinder Nut	.75	56	666	Stock Bolt	.50
70	† 735	Cylinder Wavy Spring (8) each	.25	57	667	Stock Bolt Lock Washer	.25
70A	† 736	Cylinder Spacer Washer (3) each	.25	58	668	Stock Bolt Washer	.25
18	739	Ejector	1.00	59	† 875	Trigger	8.75
20	846	Ejector Retracting Spring	.25	60	2253	Trigger Guard	7.50
51	† 873	Escapement Hook	1.00	60A	2255	Trigger Guard Assembly	26.50
66	874	Escapement Hook Spring	.25	52	649	Trigger Spring	.25
21	755	Extractor, R.H.	2.25	53	652	Trigger Spring Plunger	.25
22	1022	Extractor Spring, R.H.	.25	61	671	Trigger Guard Retaining Pin (2) each	.30
23	119	Extractor Pivot Pin	.25	62	672	Trigger Guard Ret. Pin Bushing, Front	.50
24	626	Firing Pin	1.00	63	673	Trigger Guard Ret. Pin Bushing, Rear	.50
19	627	Firing Pin Ret. and Ejector Ret. Pin	.25	64	674	Trigger Guard Ret. Pin Bushing Ret. Spring	.25
25	628	Firing Pin Retracting Spring	.25	65	699	Trigger Hinge Pin	.25
26	2235	Forehand Assembly (Checked)	17.00	67	685	Wood Plug	.25

Note: Part No. 77 Receivers are not sold for spare parts. Complete firearm must be returned to factory.
(N.I. — Not Illustrated)

ADVICE. WE MAINTAIN A SERVICE DEPARTMENT WHICH WILL PROMPTLY GIVE YOU ADVICE AND SERVICE.

INSTRUCTIONS FOR OPERATION AND CARE OF YOUR HI-STANDARD AUTOLOADING SHOTGUN

With your all-new SUPERMATIC, you now own the finest action shotgun in the world. Here are exclusives no other gun offers: "Autojstor" function that permits you to load and fire all 12 GA. 2-3/4" shells interchangeably, even mixed without any adjustment.

SUPERMATIC by Hi-Standard automatically anticipates pressures required to eject-and-load as you pull the trigger and fire! GAS-OPERATED ACTION with patented "wrap-around" cylinder is designed so that capacity is 5 shells, including one in chamber. Removable plug, with gun, reduces capacity to 3 where required. Fastest firing with softened recoil permits you to shoot 5 shells in as little as one second. The "DUCK" model is built for 3" and 2-3/4" magnum shells only.

DISASSEMBLY FOR CLEANING AND LUBRICATING

TRIGGER GUARD ASSEMBLY: Put gun "safe", push out trigger guard retaining pins. Lift trigger guard assembly from the receiver. It is not necessary to disassemble trigger guard assembly for cleaning, use brush and solvent and remove all residue. Oil lightly.

FOREHAND ASSEMBLY: Unscrew the forehand cap screw and slide forehand assembly forward off magazine tube and cylinder. Do not remove magazine tube or piston from gun. Retract piston manually and clean tube and piston parts thoroughly. DO NOT OIL. DO NOT GREASE. DO NOT LUBRICATE THESE PARTS! A greasy or oily action here will "cake" with residue and become inoperative in time. Clean frequently, for best action.

SLIDE AND BOLT ASSEMBLY: With gun upside down and muzzle pointing to the left, grasp piston firmly with left hand and pull piston fully rearward. Place index finger of right hand on face of bolt then move piston slowly forward. The slide will now rise and disengage from the action bars. Allow the piston to return slowly to its forward stop position. Slide the operating handle forward and out of the ejection port.

Hold the rear section of the slide even with the trigger guard opening (approximately 1/2" from rear shoulder of receiver) and push bolt rearward. The slide will disengage from the locking pin. By rotating the slide rearward and upward it can be removed, from the receiver. Lift out assembly from receiver.

REASSEMBLING

SLIDE AND BOLT ASSEMBLY: Place bolt back into the receiver and move it to approximately the center of the receiver. Place slide on top of the bolt and move it until it engages with the locking pin in the bolt. Position the cocking handle and then by grasping the piston, move it rearward until the action bars align with the slide notches. Push slide down into position and allow the piston to move slowly to its forward position.

TRIGGER GUARD ASSEMBLY: Make certain that hammer is in a cocked position. Then insert trigger guard assembly and replace trigger guard retaining pins from left to right.

OPERATING INSTRUCTIONS

For trouble free operation clean heavy protective oils from your shotgun before firing. After cleaning, coat parts lightly with light gun oil. For protection, your shotgun also should be cleaned and oiled lightly after shooting and before storage. Also, with an adjustable choke gun, it is wise to turn choke cap to improved cylinder setting if you intend to store the gun for extended periods.

CAUTION!

1. **DON'T PUT A 20 GAUGE SHELL IN A 12 GAUGE GUN:** The most certain way to bulge or rupture the barrel is to drop a 20 gauge shell into a 12 gauge chamber. The rim of the 20 gauge shell will catch at the bottom of the chamber and will not fall clear through the barrel. A 12 gauge shell can be loaded behind the 20 creating a serious hazard to yourself and the gun. For safety's sake do not carry 20 gauge shells when handling a 12 gauge gun.
2. **CHECK BARREL FOR OBSTRUCTIONS BEFORE LOADING AND FIRING.** Keep muzzle free from dirt, mud, water and snow or other objects which may find their way into the barrel when not in use.

NOTE!

The choke on your plain barrel gun will be identified either by the words "FULL", "MOD.", or "IMP. CYL." next to the chamber identification on the right side of the barrel or with asterisks on the left side of the barrel near the breech just above the forearm as follows:

- (*) Full Choke
- (**) Mod. Choke
- (***) Imp. Cyl. Choke

TO MAKE GUN SAFE: Safety is located in trigger-guard bow forward of trigger. Push safety button from left to right until red band is covered. This locks trigger and gun cannot be fired. Always lock the trigger when carrying a loaded gun.

TO RELEASE SAFETY: Push safety button from right to left, exposing red band, and gun is ready to fire.

TO LOAD CHAMBER: Open action fully by pulling operating handle all the way to rear. Drop shell in loading port. Push cartridge stop button and action will close, carrying shell into chamber. Push safety button from left to right.

NOTE: Avoid slamming the bolt "home" on an empty chamber. It is recommended that the cartridge stop button be depressed with the left hand while the right hand holding the bolt operating handle, allows the bolt to close gradually.

TO LOAD MAGAZINE: Hold cartridge stop button and insert shells upward into bottom of receiver, and push forward into magazine tube past cartridge stops. Repeat until magazine is full. Magazine will hold 4 shells, or 2 when plugged to conform with certain game laws (Chamber holds the additional shell).

TO REMOVE LOADED SHELLS FROM MAGAZINE: Push safety button from left to right, locking the trigger. BE SURE RED BAND ON SAFETY BUTTON IS NOT VISIBLE. Turn gun over with trigger guard up. Push cartridge stop button and depress cartridge lifter. Holding cartridge lifter down, press in cartridge stop on inside of receiver (the left side, with gun upside down) to release shell from magazine. Repeat procedure until magazine is empty. BE SURE TO REMOVE LOADED SHELL FROM CHAMBER.

TO REMOVE LOADED SHELL FROM CHAMBER WITHOUT FIRING: Be sure that safety button has been pushed from left to right, and that red band on safety button is not visible. Open action fully by pulling operating handle all the way back and loaded shell will be extracted.

PLUGGING MAGAZINE FOR 3 SHOTS: Using a coin as a screwdriver, loosen screw on fore-end cap and take off cap...

Then unscrew magazine tube cap carefully, allowing spring to emerge slowly. Put wooden plug in the center of magazine spring and reassemble. This reduces magazine capacity to only 2 shells which, with one shell in the chamber, reduces the gun's total capacity to 3 shells, as required by the game laws of certain states.

CHOKE CONTROL ADJUSTMENTS: Turn the knurled sleeve clockwise as far as it will go. Then back off very slightly until the sleeve clicks and the words "X-FULL" line up with the front sight. This shows that the CHOKE CONTROL is adjusted to throw the tightest choke pattern. To decrease the degree of choke, unscrew the sleeve counterclockwise a click at a time. The markings that line up with front sight at each click tell you the degree.